

Instruction Guide | Side Chairs

U.S. & Canada (888) 520-4998 | International (801) 875-4998 | www.mti.net

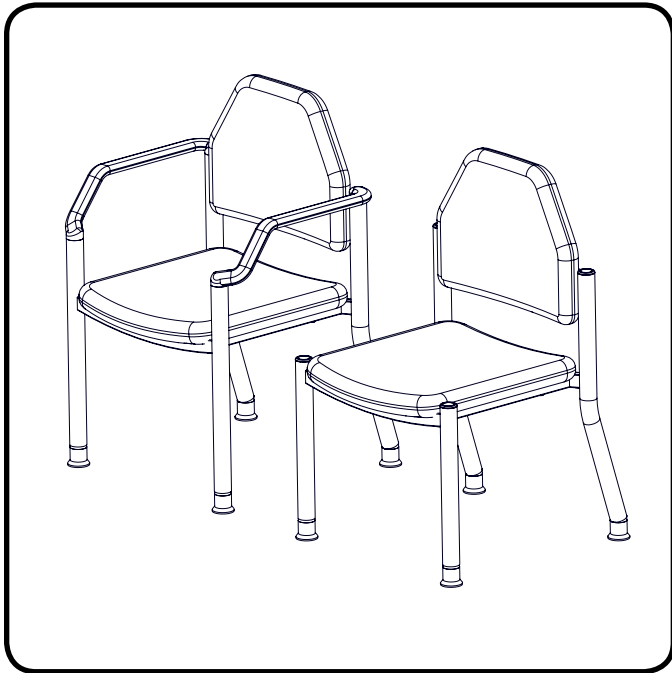

! WARNING/AVERTISSEMENT

Read this manual before installation and use.

Lisez ce manuel avant l'installation et l'utilisation.

Required Tools

	Phillips Screwdriver
---	-------------------------

This manual is for the following part numbers:

PART NUMBER	DESCRIPTION
301-XX-XXX	Side Chair w/o Arms
302-XX-XXX	Side Chair w/Arms

REVISION HISTORY TABLE

DATE	REVISION	CO#/ECO#	DETAILS
04/02/2015	A	CO-0074	Initial release

Assembly

To assemble a side chair follow the steps below:

1. Attach the upholstered seat cushion to the frame of the chair using the M6 x 45mm bolts with a Phillips screwdriver (Figure 1).
2. Attach the upholstered back cushion to the frame of the chair using the (4) #10 x 1-1/4" wood screws with a Phillips screwdriver (Figure 2).
3. Twist feet to level the chair on uneven surfaces (Figure 3).

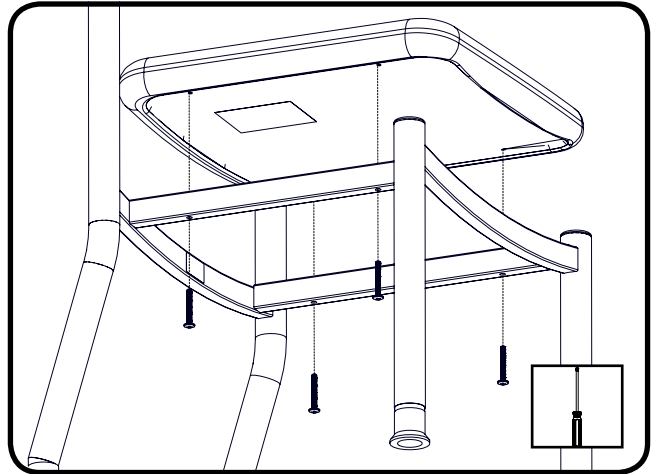

Figure 1

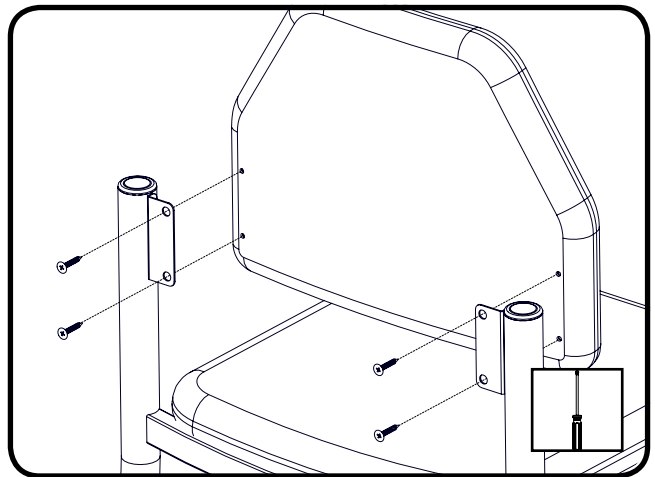

Figure 2

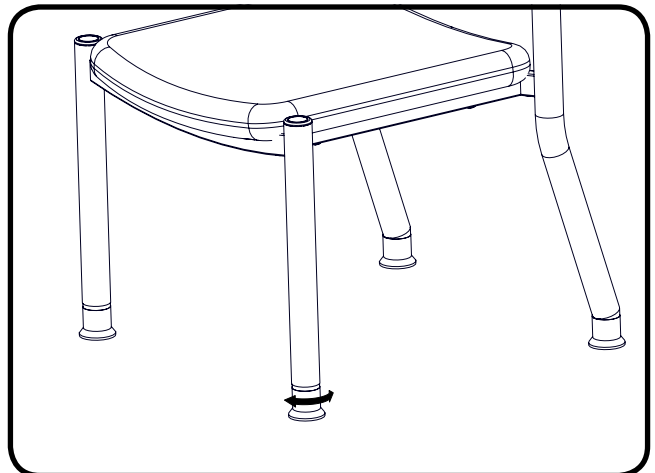

Figure 3

EXPLODED VIEWS

301 XX-XXX SIDE CHAIR W/O ARMS

PART NUMBER	QTY	DESCRIPTION
130-0002	1	SIDE CHAIR w/o ARMS, UNIPHOLSTERED
130-0011	1	FRAME, SIDE CHAIR w/o ARMS
130-0009	4	LEVELING FOOT, SIDE CHAIR
130-0013	4	BUGLE HEAD PHILLIPS WOOD SCREW, 10 X 1-1/4 BLACK
130-0012	4	TRUSS HEAD PHILLIPS SCREW, M6-1.0 X 45 ZINC
130-0016	4	END PLUG, SIDE CHAIR
130-0004-XX-XXX	1	UPH CUSHION, SIDE CHAIR SEAT
130-0005-XX-XXX	1	UPH CUSHION, SIDE CHAIR BACK

THE XX OF DRAWING/PART NUMBER REFERS TO CONSTRUCTION CODE.
 THE XXX OF DRAWING/PART NUMBER REFERS TO COLOR CODE.
 CONTACT MTI FOR SPECIFIC COLOR AND CONSTRUCTION CODES.

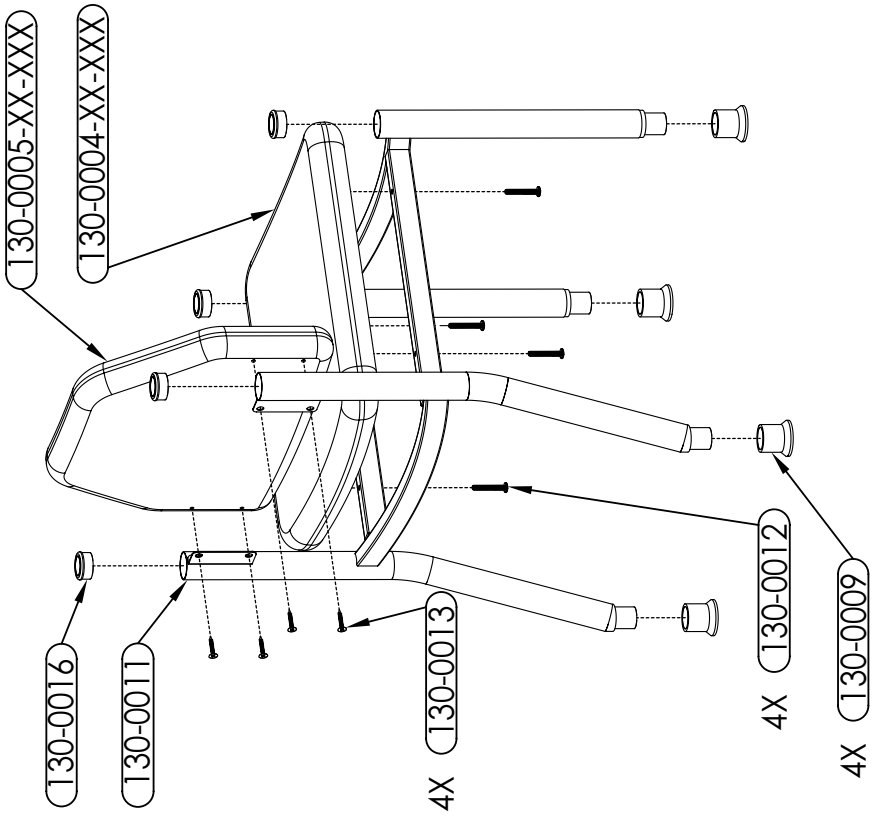

302-XX-XXX SIDE CHAIRS W/ARMS

PART NUMBER	QTY	DESCRIPTION
130-0003	1	SIDE CHAIR w/ARMS, UNIPHOLSTERED
130-0010	1	FRAME, SIDE CHAIR w/ARMS
130-0009	4	LEVELING FOOT, SIDE CHAIR
130-0013	4	BUGLE HEAD PHILLIPS WOOD SCREW, 10 X 1-1/4 BLACK
130-0012	4	TRUSS HEAD PHILLIPS SCREW, M6-1.0 X 45 ZINC
130-0004-XX-XXX	1	UPH CUSHION, SIDE CHAIR SEAT
130-0005-XX-XXX	1	UPH CUSHION, SIDE CHAIR BACK

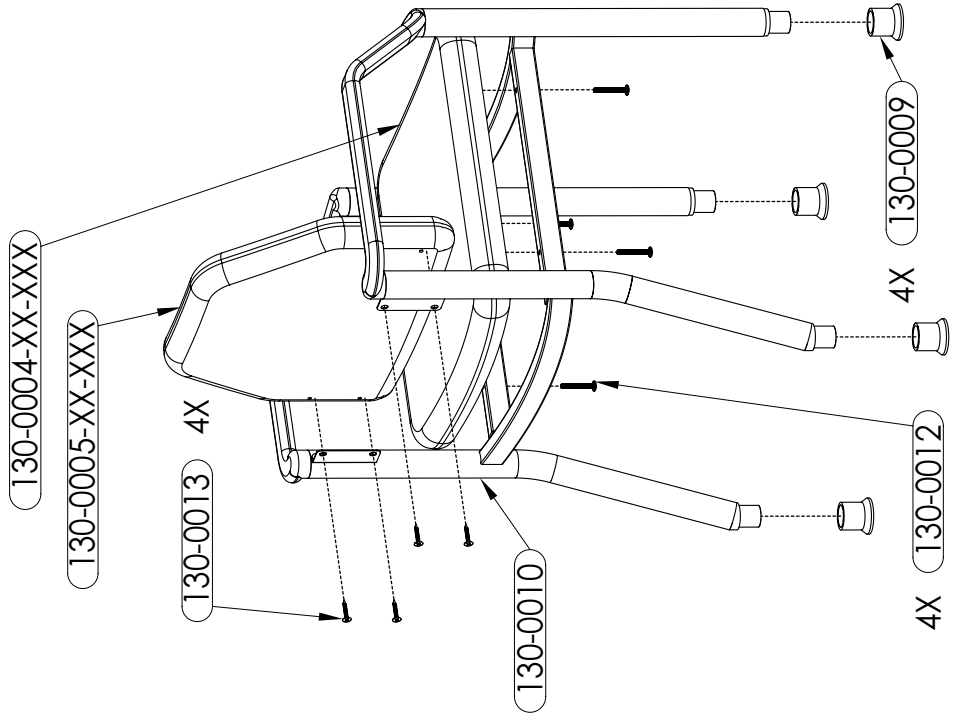

⚠ WARNING/AVERTISSEMENT

See main equipment's User Manual for use instructions and all symbols, warnings, and cautions.

Consultez le manuel d'utilisation de l'appareil principal pour les instructions d'utilisation et tous les symboles, les avertissements et mises en garde.

⚠ WARNING/AVERTISSEMENT

No modification of this equipment is allowed.

Aucune modification de cet équipement est autorisé.

⚠ WARNING/AVERTISSEMENT

Assure equipment, patient, and other objects are in safe condition before operating the equipment.

Assurer l'appareil, patient, et d'autre objets sont dans un état sûr avant d'utiliser l'appareil.

⚠ WARNING/AVERTISSEMENT

This product contains chemicals known to the State of California to cause cancer and/or birth defects or other reproductive harm. See <http://www.mti.net/FAQs.aspx> for details on California Proposition 65.

Ce produit contient des produits chimiques reconnus par l'État de Californie pour causer le cancer et / ou des anomalies congénitales ou d'autres problèmes de reproduction. Voir <http://www.mti.net/FAQs.aspx> pour plus de détails sur la California Proposition 65.

Cleaning and Disinfection

See "MTI Cleaning Solution Recommendation Letter" for more details on disinfecting solutions which have been tested on MTI's products. It is available for download at <http://www.mti.net/downloads.aspx> in the Product Support Bulletins folder, found under the Resources tab on our website. Or, in the U.S. & Canada call, (888) 520-4998, or International, call (801) 875-4998 to request a copy.

Painted and Plastic Surfaces

All painted metal parts have been electrostatically painted

and the paint is baked on for durability. Weekly, those surfaces should be wiped down with a quality grade cleaner and a soft cloth or a damp cloth with mild soap.

Upholstery

Upholstery should be cleaned weekly with a mild liquid soap and water mixture. Afterwards, wipe upholstery with a clean damp cloth.

Calls for Service

(888) 520-4998 | International (801) 875-4998
customer.service@mti.net | www.mti.net

LIMITED WARRANTY

Medical Technology Industries, Inc. (hereinafter referred to as MTI), shall repair or replace products of its manufacture, which prove to be defective in material and/or workmanship for a period of twelve (12) months from the date of shipment to the customer (the "Warranty Period"). MTI will, at its option, provide parts to the customer or repair the defective part at MTI's factory or authorized repair facility. Except as it may otherwise specifically agree in writing, MTI shall not be liable for transportation or labor charges for repairs or adjustments or other work done on any of its products by MTI's authorized dealers or service organizations.

Customer shall notify MTI of any alleged claim or defect within fourteen (14) days from the date customer discovers, or upon reasonable inspection should have discovered, such alleged claim or defect (but in any event before the expiration of the Warranty Period). All repair parts are warranted for Ninety (90) calendar days from the date of shipment to the customer. Warranty is non-cumulative.

This warranty does not apply to any part or product which upon examination by MTI or its authorized agents indicates the product has been repaired or altered in any way by persons other than MTI or its authorized agents, has been misused, abused or used in a manner contrary to any instructions issued by MTI. Any parts or products claimed under this warranty must be properly packaged by customer and returned to MTI's factory with no liability to MTI for the parts, products or transportation charges thereon.

In no event, shall MTI have any liability for consequential, indirect, incidental, special, exemplary, punitive or enhanced damages, lost profits or diminution in value arising out of or relating to a product defect or the repair or replacement of any products manufactured or sold by it.

THE FOREGOING LIMITED WARRANTY IS MADE IN LIEU OF ALL WARRANTIES EXPRESSED OR IMPLIED, AND MTI MAKES NO OTHER WARRANTY WHATSOEVER WITH RESPECT TO THE PRODUCTS INCLUDING BUT NOT LIMITED TO, ANY IMPLIED WARRANTY OR MERCHANTABILITY OR FITNESS FOR A PARTICULAR PURPOSE.

3655 W Ninigret Drive, Salt Lake City, Utah, 84104-6572
(800) 924-4655 • (801) 875-4999 • Fax (801) 952-0548

www.mti.net



Strength in patient care.™

© MTI, Inc. All rights reserved.
MTI reserves the right to make any
product changes without notice.

073160 Rev A